

PHOENIX CONVENTION CENTER

South Building | 100 Level | Street Level

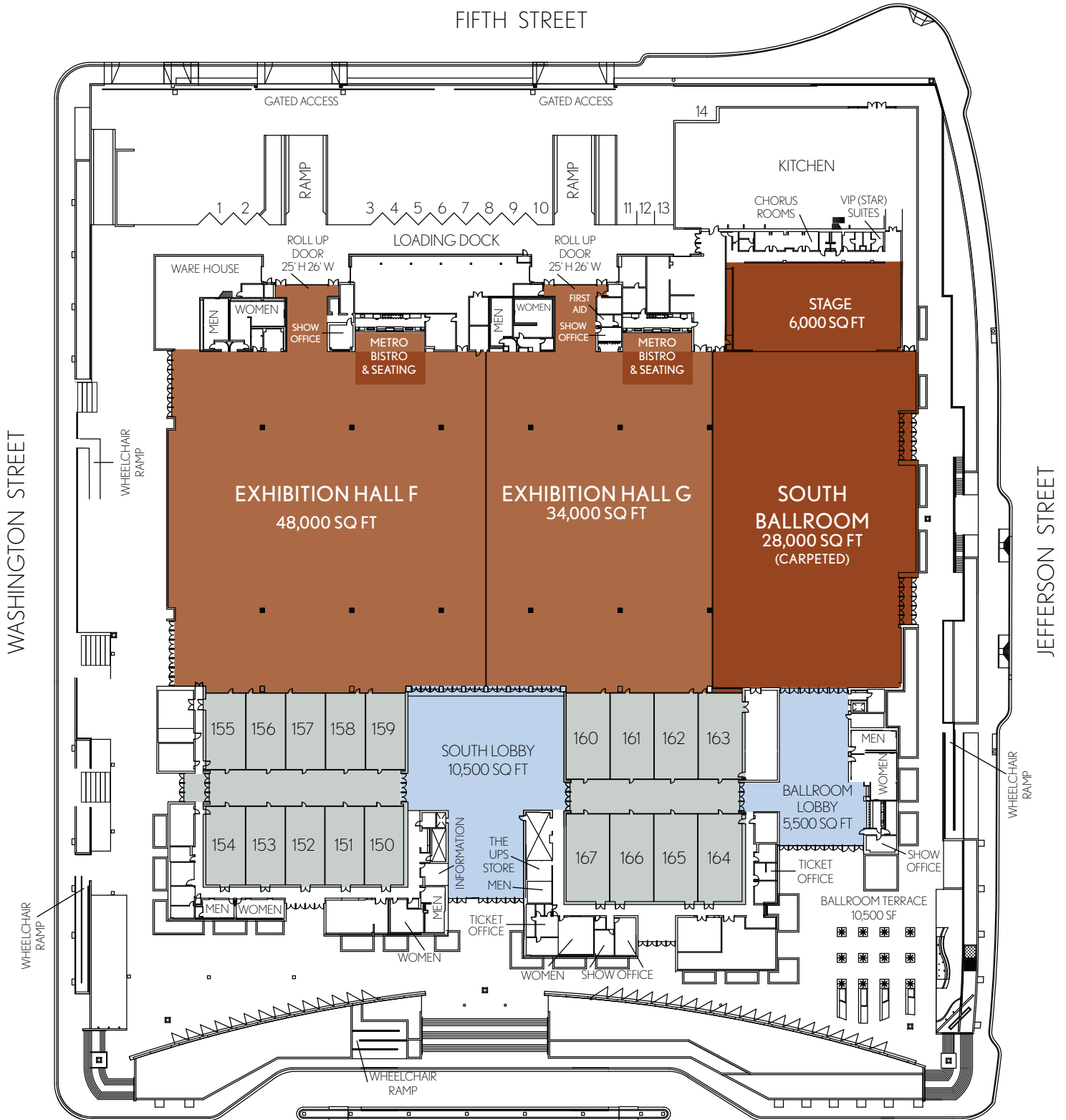

150-154 - 1,400 SQ FT EA.
 155-159 - 1,300 SQ FT EA.
 160-169 - 1,700 SQ FT EA.

THIRD STREET



PHOENIX CONVENTION CENTER

South Building | 100 Level | Street Level

MEETING/EXHIBITION SPACE

HALLS - STREET LEVEL	AREA (SF*)	DIMENSIONS	CEILING HGT.	THEATER	SCHOOL	BANQUET	EXHIBITS
HALL F	48,000	212' x 229'	27'	4,200	3,000	2,700	248
HALL G	34,000	151' x 229'	27'	3,800	2,800	1,900	178
BALLROOM	28,000	125' x 226'	27'	3,180	2,100	1,700	149
ROOMS - STREET LEVEL							
150-159 (Entire Room)	17,000	129' x 134'	16'	2,350	1,280	1,020	**80
150-154 (Each)	1,400	26' x 53'	16'	170	80	60	
155-159 (Each)	1,300	26' x 51'	16'	170	80	60	
160-167 (Entire Room)	16,400	118' x 140'	16'	2,190	1,230	1,040	**80
160-167 (Each)	1,700	29' x 59'	16'	200	120	70	
TOTAL	143,400	Includes meeting rooms, corridors in open condition.					735
OTHER SPACE							
SOUTH LOBBY	10,500						
BALLROOM LOBBY	5,500						
BALLROOM TERRACE	10,500						

*SF Area is rounded.

** When used as exhibition space with Halls F/G.

The Phoenix Convention Center's South Building offers 143,400 square feet of versatile event space that can be transformed to suit any event. The building features two exhibition halls (48,000 and 34,000 square feet), a 28,000 square-foot ballroom, and nearly 34,000 square feet of divisible meeting space. Two spacious lobbies and the 10,500 square-foot outdoor Ballroom Terrace provide additional event-space options. This building has a 600 pounds/square foot weight capacity.

The South Building boasts several unique features. The full-service South Ballroom offers numerous permanent amenities including a 6,000 square-foot stage, built-in lighting and sound technology, an audio-visual control bridge and four chorus and three VIP (Star) dressing rooms. Additionally, the building's flexible meeting space can be divided to create as many as 18 separate meeting rooms, or completely opened to provide additional exhibition hall space. On-the-floor show offices, public announcement and stereo sound systems, dimmable lighting, and a kitchen capable of catering for 5,000 guests complement this functional venue.

For easy access and move-in, the South Building offers 14 street-level truck bays and two loading ramps, both with 26' W x 25' H dock doors. Adjacent parking garages with more than 4,000 spaces provide convenient options for guests visiting this venue.

For more information, or to reserve event space at Arizona's latest greatest wonder, please call: 800.282.4842 or visit: phoenixconventioncenter.com

100 North Third Street | Phoenix, AZ 85004
602.262.6225 | TTY 602.495.5048